



# Solar Moon Light

patent all in one solar led street light



## Detailed Spec of Solar Moon Light



Patent product    **CE**   **RoHS**   **FC**   **cac**   IP65

### Advantage:

- Remote control-Simple operation, change to different modes easily.
- Wireless application-Integrated solar panel, LED, lithium battery, micro-controller and other accessories into one system, simple and stylish.
- Micro-computer controlled-Combine motion sensor system, light control system and time control system perfectly, ensure whole system more energy-efficient.
- Easy installation-No power required, no cables required, easy installation in 2 minutes.
- Solar panel angle adjustable-Adjustable in vertical and horizontal direction, ensure maximum efficiency of solar energy conversion.
- Extreme light-Light efficiency reach 160lm/w, at same illumination, lower watt available.
- Lithium battery-Adopt lithium battery to replace traditional gel battery, longer lifetime.
- Modular design-All components are modular design and in standardized production.
- Long time working-Working continuously for 2-3 rainy days.
- Low cost-Compared with traditional solar led lights, much lower cost, easy to transport.

## Feature:

- Beautiful and modern appearance, simple and fashionable.
- Use of solar green energy, environment friendly, saving more.
- Low voltage driving, meet the Europe standard of CE RoHS FCC.
- No Hg, Pb or other hazardous materials, no radiation, human safety.
- IP65 grade, TVS lightning protection.
- Long lifetime of whole lamp, low maintenance costs.

## Details:

### Monocrystalline



- 18% photoelectric conversion efficiency
- Tempered glass cover
- 20-25 years lifetime

### High lumen led chip



- 45mil led chip, 160lm/w
- ≥50000hrs lifetime
- ≥70Ra CRI

### Unique Smart Controller



- unique design
- 6 control modes, light control, motion sensor control, time control, motion sensor and time control, demo mode, off mode.
- Smart control, saving more and system works stably

### LiFePO4 battery



- High capacity
- No pollution and stable
- 5-8 years lifetime, ≥2000 times charge & discharge
- High temperature resistance

### High quality body



- Unique patent design
- Aluminum alloy, solid and firm
- Zinc plated, anti-rust corrosion
- Variety of installation methods

### "Moon" shape cover







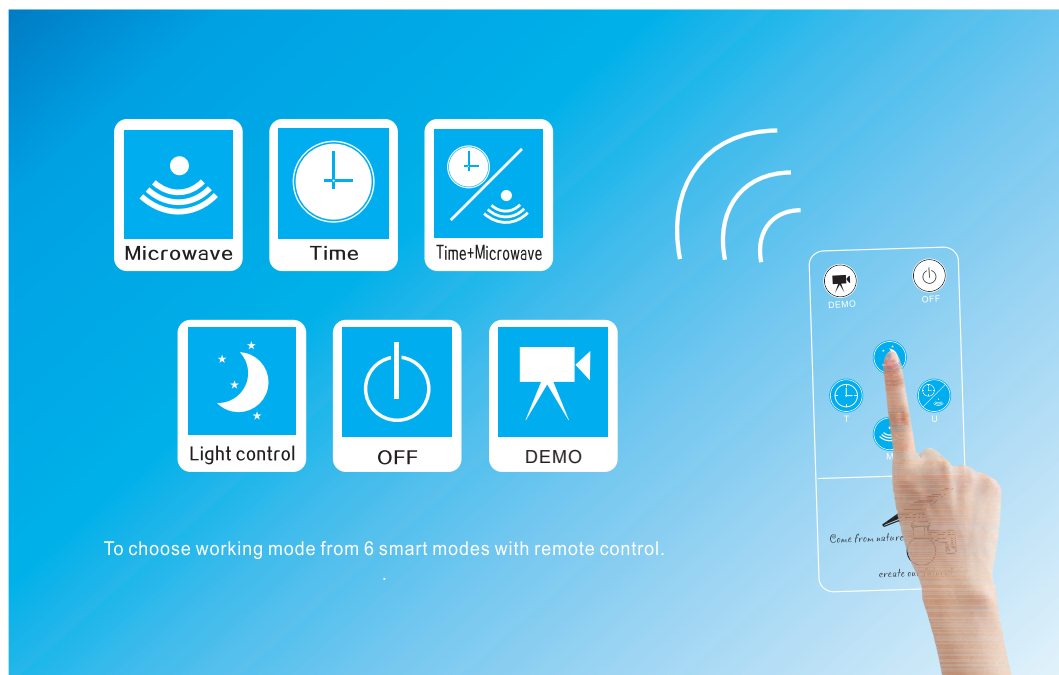

- 95% high light transmittance
- Strip cover, soft lighting for eyes
- High quality PMMA, long lifetime

## ■ Remote Control



## ■ Six working mode choices

-  **DEMO:** No matter day or night, light "on" when people close, light "off" after people left. Only for test use.
-  **OFF:** Light "off", no matter day or night.
-  **L:** At night, 100% light for 2hours, 80% for another 2hours, then light 50% till the dawn. Lighting for 1.5days.
-  **T:** At night, 100% light for 2hours, 60% light for another 2hours, then light "off". Lighting for 3days.
-  **U:** At night, 100% light for 2hours, 60% light for another 2hours, then turn to motion sensor, 60% light when people close, 20% light after people left. Lighting for 2days.
-  **M:** At night, 100% light when people close, 30% light after people left. Lighting for 2.5days.

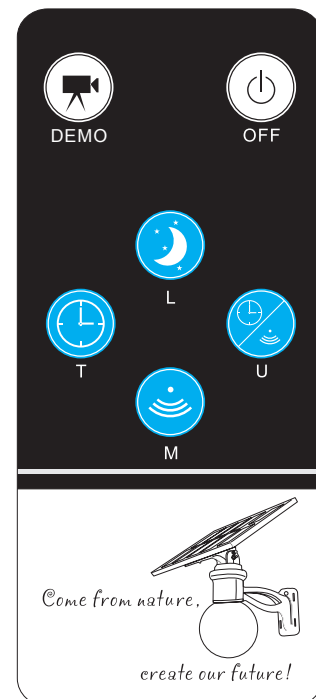

**Remark:** Default is U mode, you can choose the best mode according the light condition in your city.

## ■ Attentions of motion sensor function

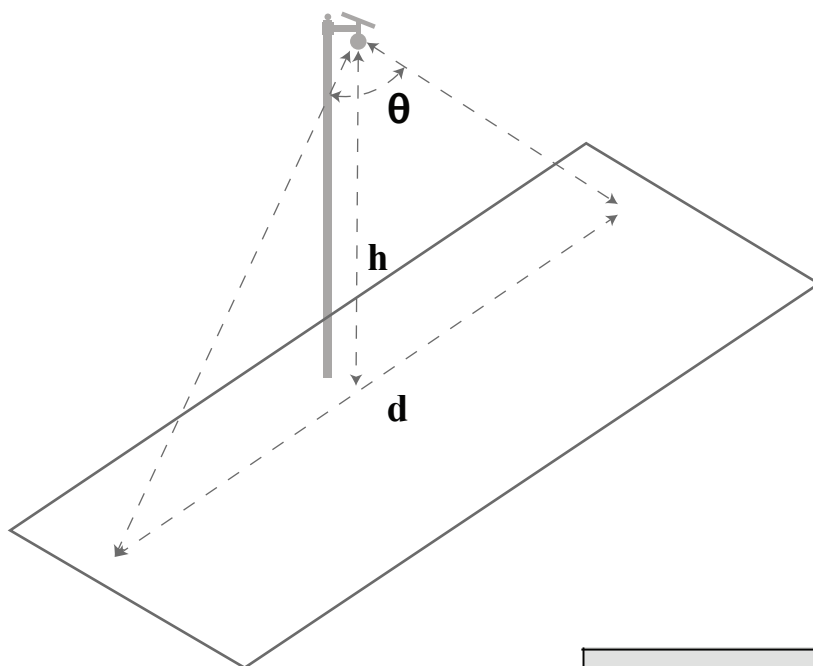

$\theta$ ( Angle )	h ( Height )	d ( width )
$65^{\circ}$	6m	10m

1. Sensor area tested from a person at the average height of 1.6~1.7m, walking speed for 1.0~1.5 m per second. If testing standard different, sensor area will be different.
2. Sensor functions are greatly influenced by metal environment, so pls install it far away metal block.
3. Sensor against the metal block in front of it.
4. Sensor can get through glasses, wood board, plasterboard and other non-metallic object.
5. Sensor should be installed under 6m height.



## Applications:

Widely used in Park, Villa, Village, Square, Courtyard, Farm, School, Desert, Prairie, Path etc...the places where need outdoor lighting and with enough sunshine.



## Easy installation in 2 minutes!

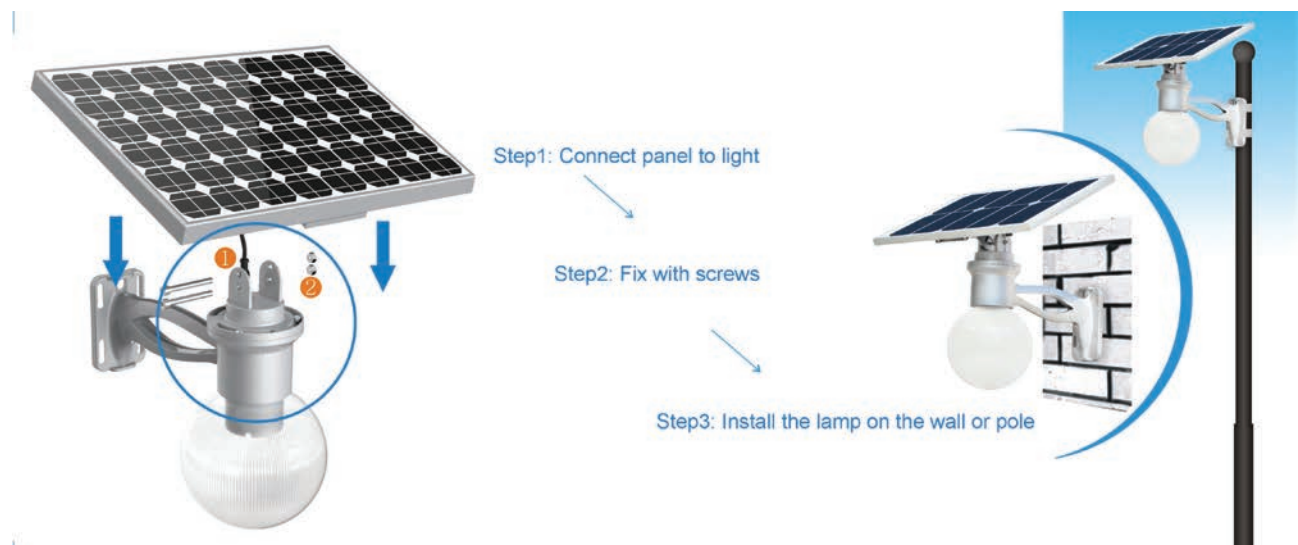

## Solar panel angle adjustable schematic diagram:



## Parameters:

Type	SC-ML-R12	SC-ML-R25	SC-ML-R40
Lamp power	4W	8W	12W
Solar panel	12W/5V	25W/5V	40W/13.5V
Lithium battery	10AH/3.2V	20AH/3.2V	10AH/9.6V
LED qty	6pcs	6pcs	12pcs
Luminous flux	600-720lm	1200-1440lm	1500-1800lm
LED chip	Bridgelux		
Color temperature	3000-6500K		
CRI	≥70Ra		
Light control voltage	1V		
Illumination (stand by)	30%		
Sensor area	<10meters		
Delay time	20s		
Charge time (full sunlight)	4hrs		
Working temperature	-20℃~+60℃		
Lifetime	≥50000hours		
Material	High quality aluminum alloy, die-cast aluminum		
Mounting height	3-6meters		
Installation spacing	8-10meters		

The data of its working time was measured at latitude 22 °, 113 ° east longitude in sunny days.  
The working time will be affected by the surroundings.

## Moon light dimension

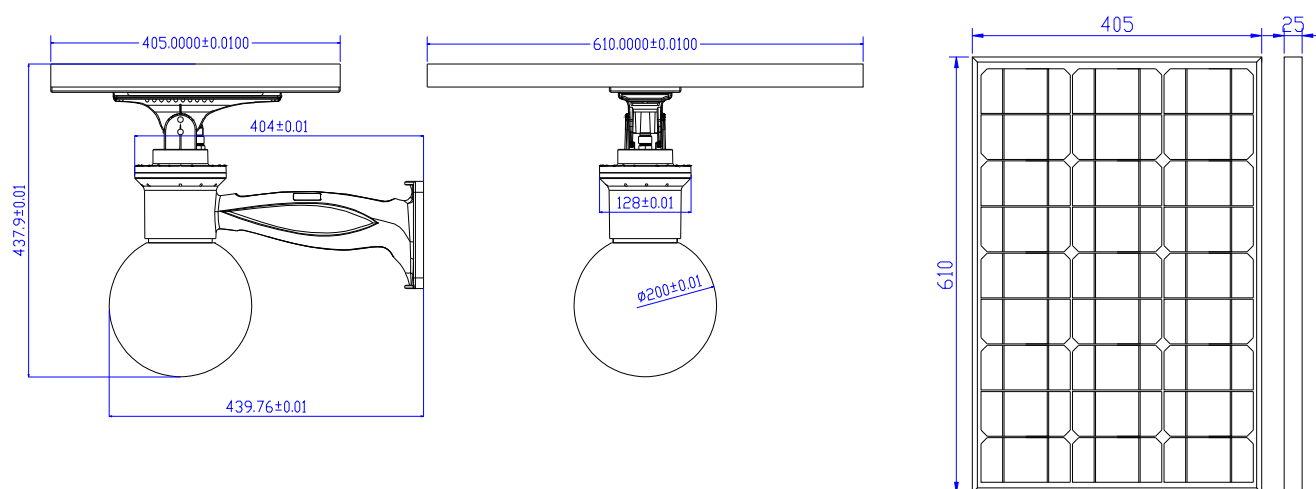
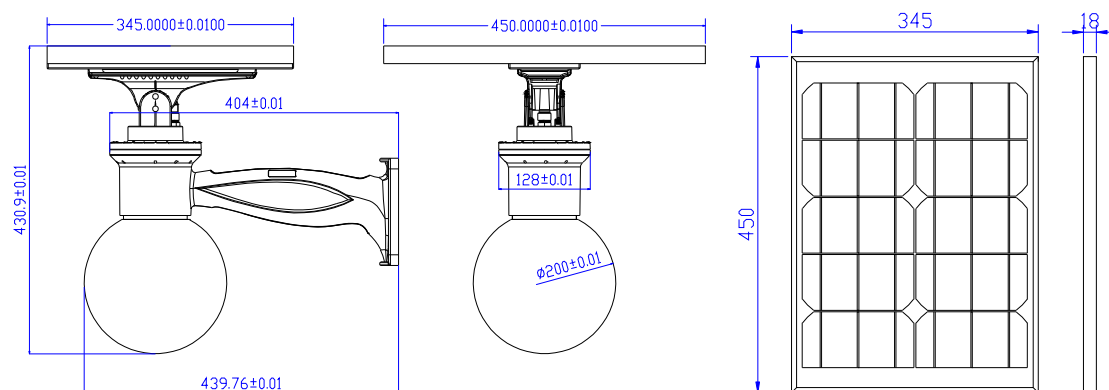
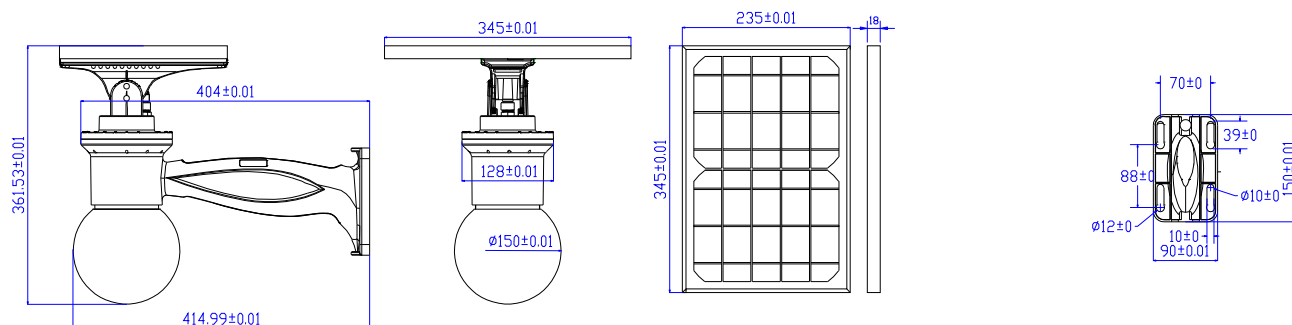



## Using Instructions:

- Solar Moon light, need solar power to charge battery, please select appropriate model based on local sunshine conditions.
- Please avoid solar panel be block by building, trees or other obstructions, otherwise it will reduce efficiency of solar panels working, resulting in lower efficiency of system.
- Charging temperature of Lithium battery is 0°C to 55°C, the discharging temperature is -20°C to 60 °C, make sure that ambient temperature is in this range when used, avoid damage to lithium battery.
- Please cleaning surface of solar panels regular, such as dirt, leaves, oil, etc., ensure high photoelectric conversion efficiency.
- Cleaning snow of solar panel surface timely in winter.

## Package specification:

Two lamps in one box.

Type	Box size(L*W*H)	Net Weight	Gross Weight	20GP	40GP
SC-ML-R12	460*340*300mm	7kg	11kg	1100pcs	2400pcs
SC-ML-R25	490*385*300mm	9.5kg	14kg	900pcs	1900pcs
SC-ML-R40	660*475*270mm	15kg	21kg	600pcs	1300pcs

Color box packaged, anti-shock packaging material, with bubble bags and foam, ensure transport safety.



## List of accessories

- 304 expansion screws & spacer & nut.....4sets
- Fixed the back light pole.....1pc
- 304 hexagonal screw M6 & nut.....2sets
- 304 hexagonal screw M6.....3pcs
- Hexagon wrench M5.....1pc
- Open spanner M10.....1pc
- Remote control.....1pc

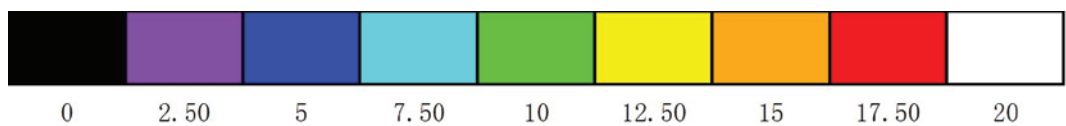
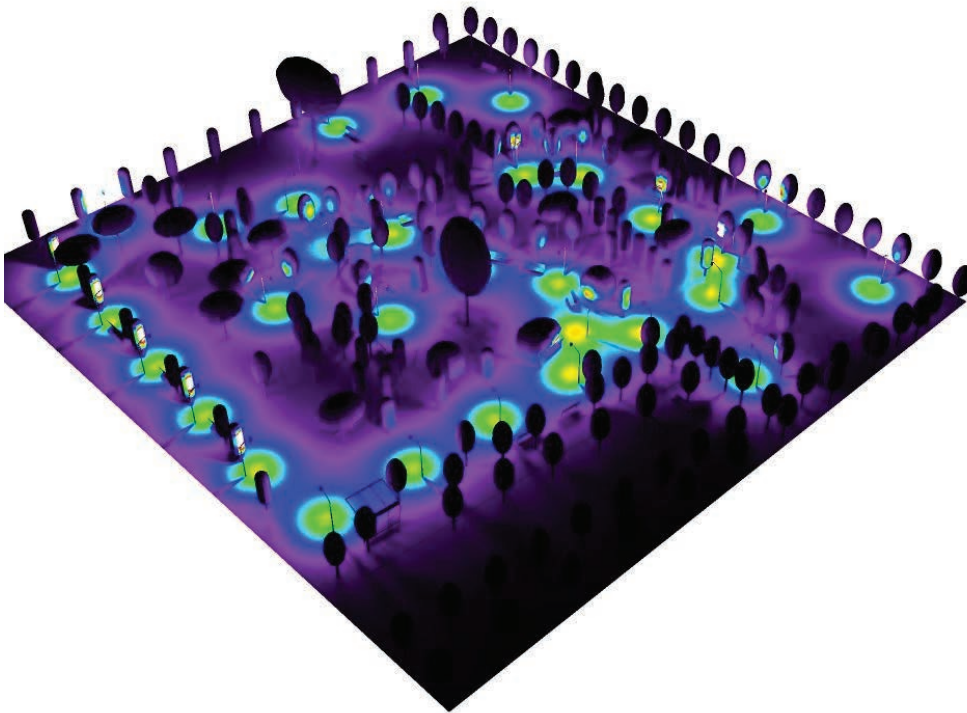
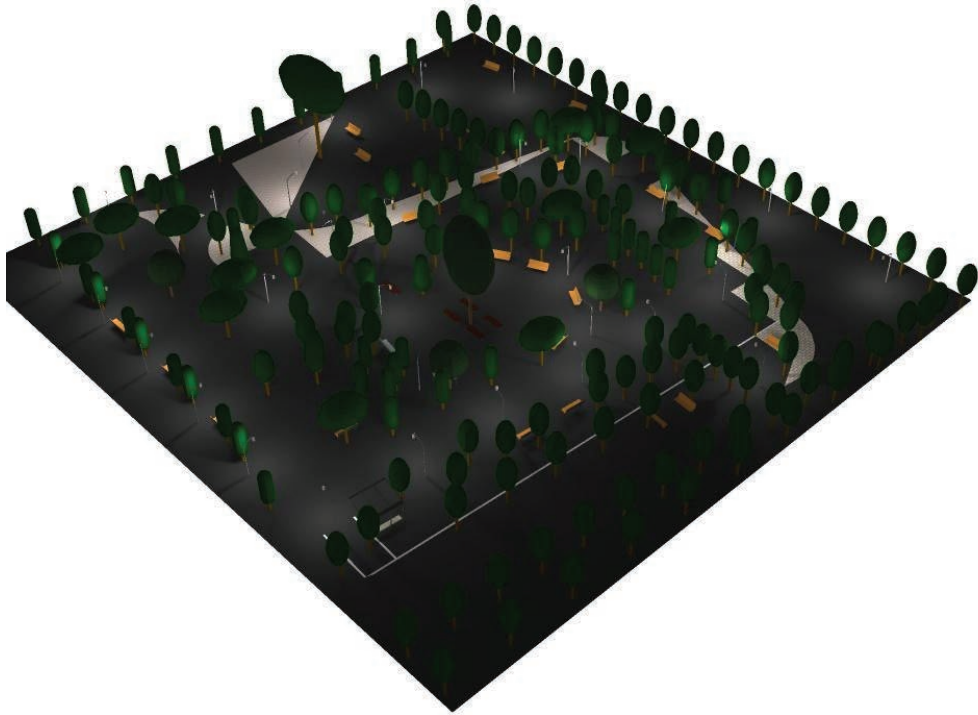

lx